

Neri SpA is constantly committed to research and design for products of high quality, durability and safety. This manual aims to present correct installation procedures for pole system as a guide for professional installers. To this end the manual should be read with extreme attention.

Project location:			
Project name:			
Model #:	ANEB.501.203 - ANEB.501.205	Date	

The Nebula system allows numerous configurations. The number of fixing devices for luminaires and accessories varies according to the main structure of the chosen post.

1 - Main post structure

2 - Hand hole

3 - Fixing devices that can only be used for the installation of accessories

4 - Fixing devices for luminaires and accessories

5 - Compensation tube (variable length depending on the chosen configuration)

6 - Closing element

7 - Base post accessory

8 - Terminal element with provision for auxiliary devices

Cod. **ANEB.501.203**

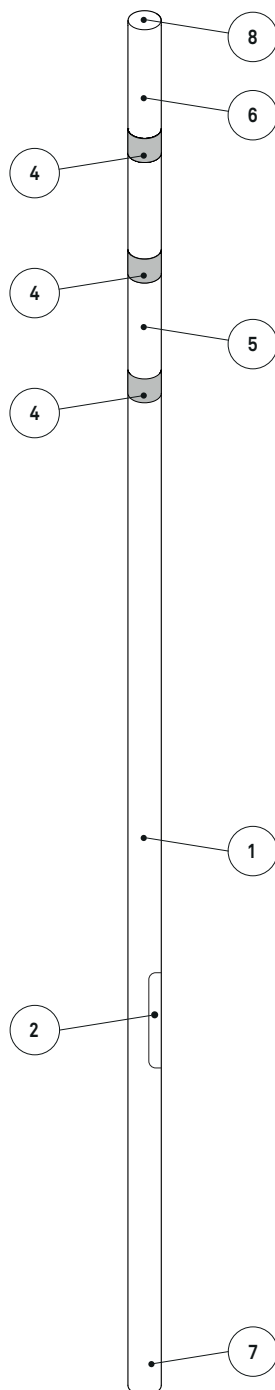

Cod. **ANEB.501.205**

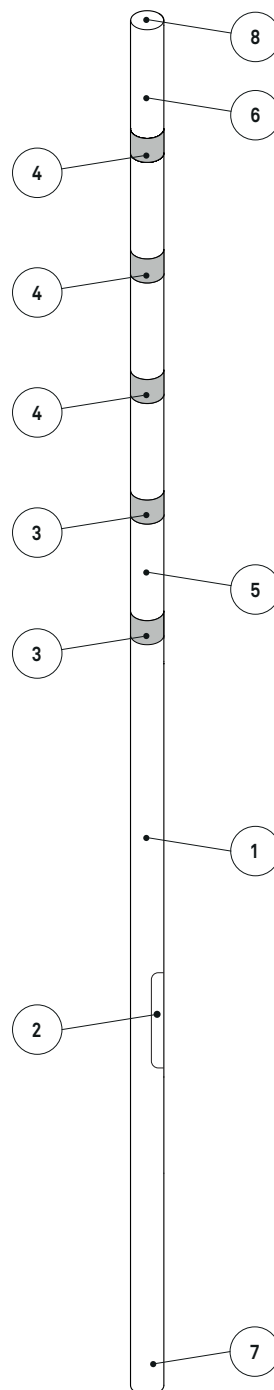

Project location:			
Project name:			
Model #:	ANEB.601.203 - ANEB.601.207	Date	

The Nebula system allows numerous configurations. The number of fixing devices for luminaires and accessories varies according to the main structure of the chosen post.

1 - Main post structure

2 - Hand hole

3 - Fixing devices that can only be used for the installation of accessories

4 - Fixing devices for luminaires and accessories

5 - Compensation tube (variable length depending on the chosen configuration)

6 - Closing element

7 - Base post accessory

8 - Terminal element with provision for auxiliary devices

Cod. **ANEB.601.203**

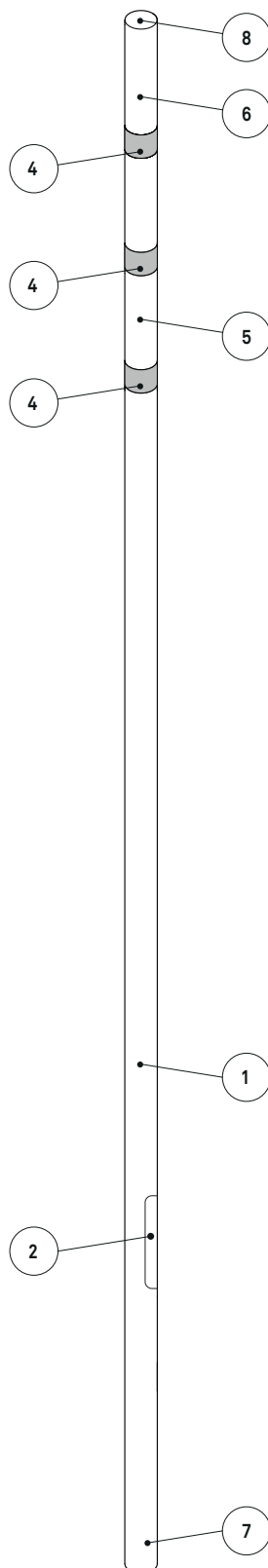

Cod. **ANEB.601.207**

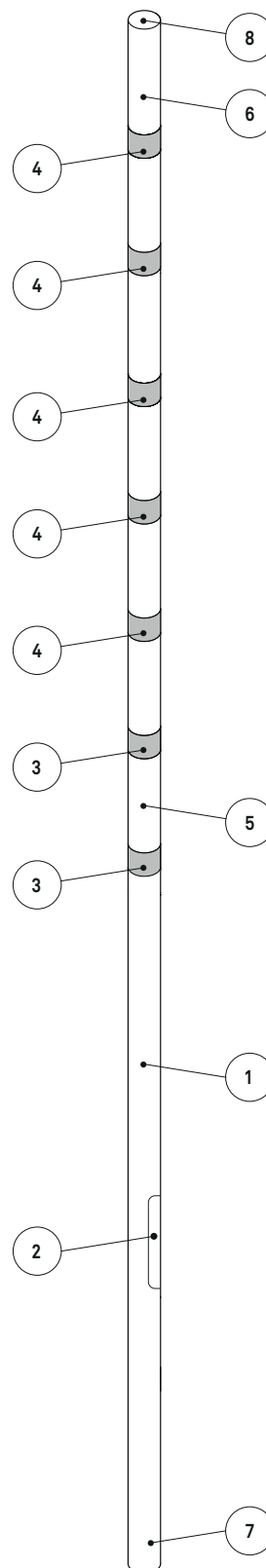

Project location:			
Project name:			
Model #:	ANEB.701.203 - ANEB.701.209	Date	

The Nebula system allows numerous configurations. The number of fixing devices for luminaires and accessories varies according to the main structure of the chosen post.

1 - Main post structure

2 - Hand hole

3 - Fixing devices that can only be used for the installation of accessories

4 - Fixing devices for luminaires and accessories

5 - Compensation tube (variable length depending on the chosen configuration)

6 - Closing element

7 - Base post accessory

8 - Terminal element with provision for auxiliary devices

Cod. **ANEB.701.203**

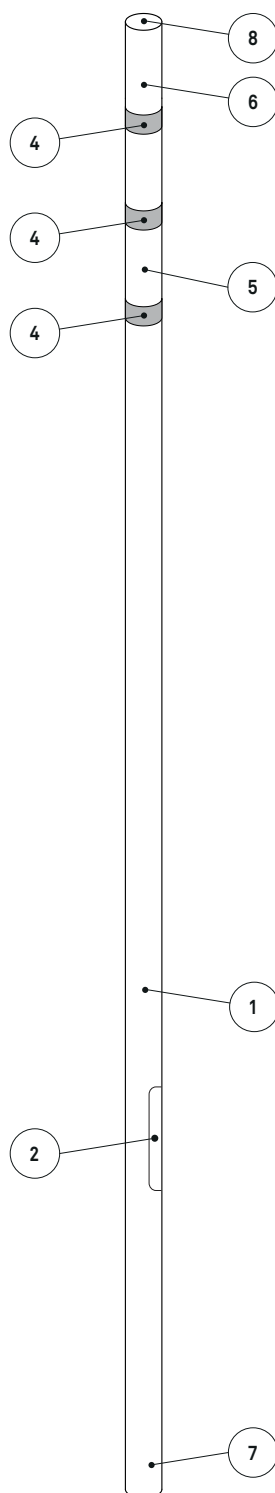

Cod. **ANEB.701.209**

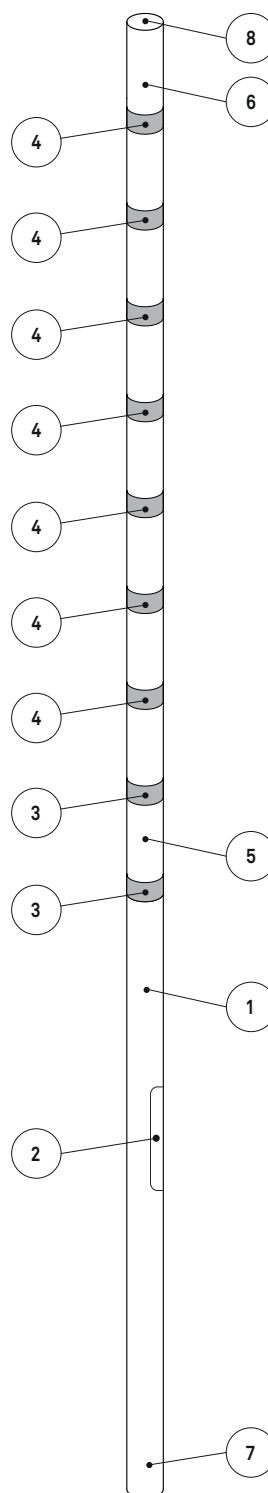

Project location:			
Project name:			
Model #:	ANEB.801.203 - ANEB.801.211	Date	

The Nebula system allows numerous configurations. The number of fixing devices for luminaires and accessories varies according to the main structure of the chosen post.

1 - Main post structure

2 - Hand hole

3 - Fixing devices that can only be used for the installation of accessories

4 - Fixing devices for luminaires and accessories

5 - Compensation tube (variable length depending on the chosen configuration)

6 - Closing element

7 - Base post accessory

8 - Terminal element with provision for auxiliary devices

Cod. **ANEB.801.203**

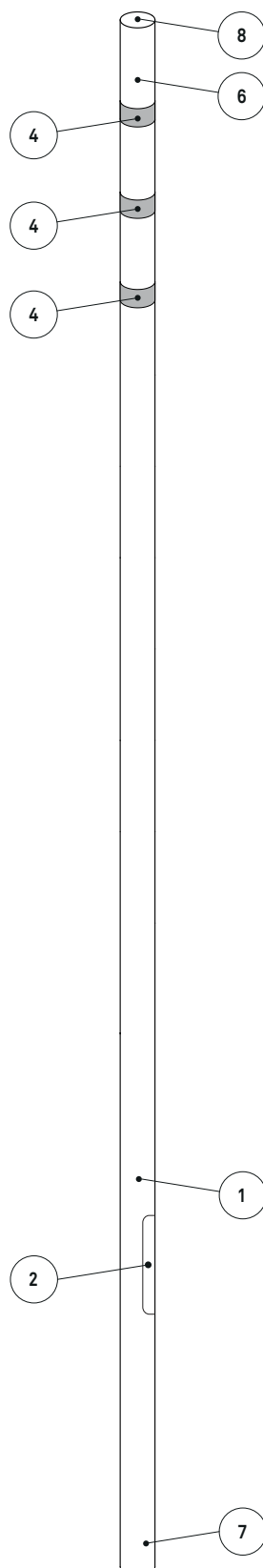

Cod. **ANEB.801.211**

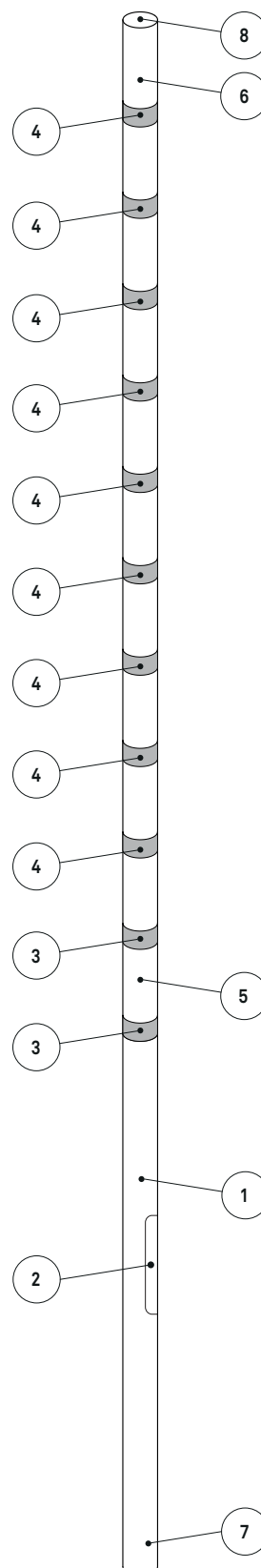

Project location:			
Project name:			
Model #:	FLANGE	Date	

FLANGE

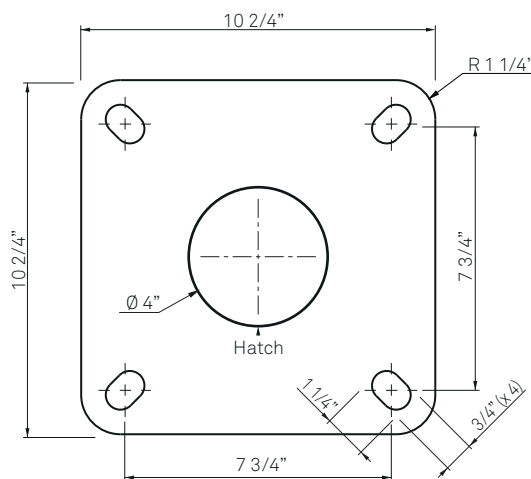
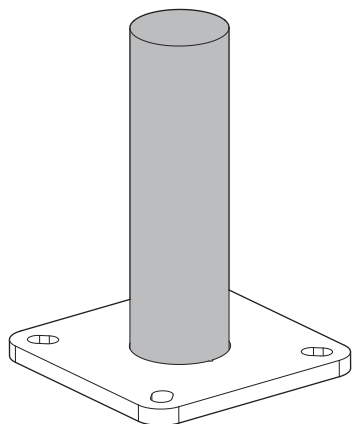

Fig. A

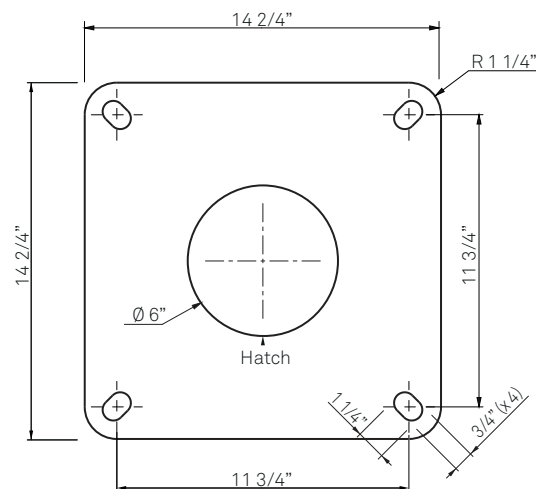

Fig. B

The lighting posts of the Nebula collection are designed for flange mounting to a foundation plinth (Fig. C).

We recommend installation with a concealed flange positioned 3 7/8" below the final floor level (Fig. D).

- The characteristics and length dimensioning of the fixing bolts are the construction manager's responsibility or system designer.

Flange detail:

- Square flange 10 2/4" x 10 2/4" (thickness 3/4") to be fixed with 4 anchor bolts to the foundation plinth, provided with 4 slots (3/4" x 1 1/4") arranged at 90° to each other (Fig. A). Fasteners and fixing bolts not supplied.

- Square flange 14 2/4" x 14 2/4" (thickness 3/4") to be fixed with 4 anchor bolts to the foundation plinth, provided with 4 slots (3/4" x 1 1/4") arranged at 90° to each other (Fig. A). Fasteners and fixing bolts not supplied.

Please refer to the specific data sheets of the posts used.

Flange for posts H 15' and H 18'

Cod. ANEB.501.203

Cod. ANEB.501.205

Cod. ANEB.601.203

Cod. ANEB.601.207

Flange for posts H 21' and H 24'

Cod. ANEB.701.203

Cod. ANEB.701.209

Cod. ANEB.801.203

Cod. ANEB.801.211

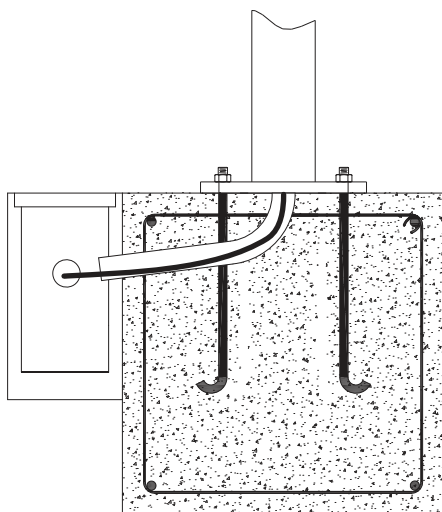

Fig. C

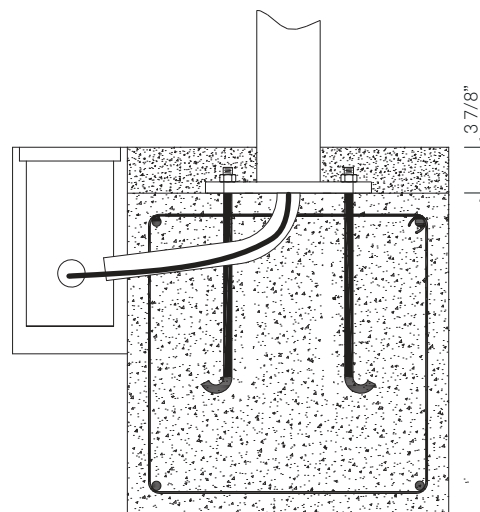
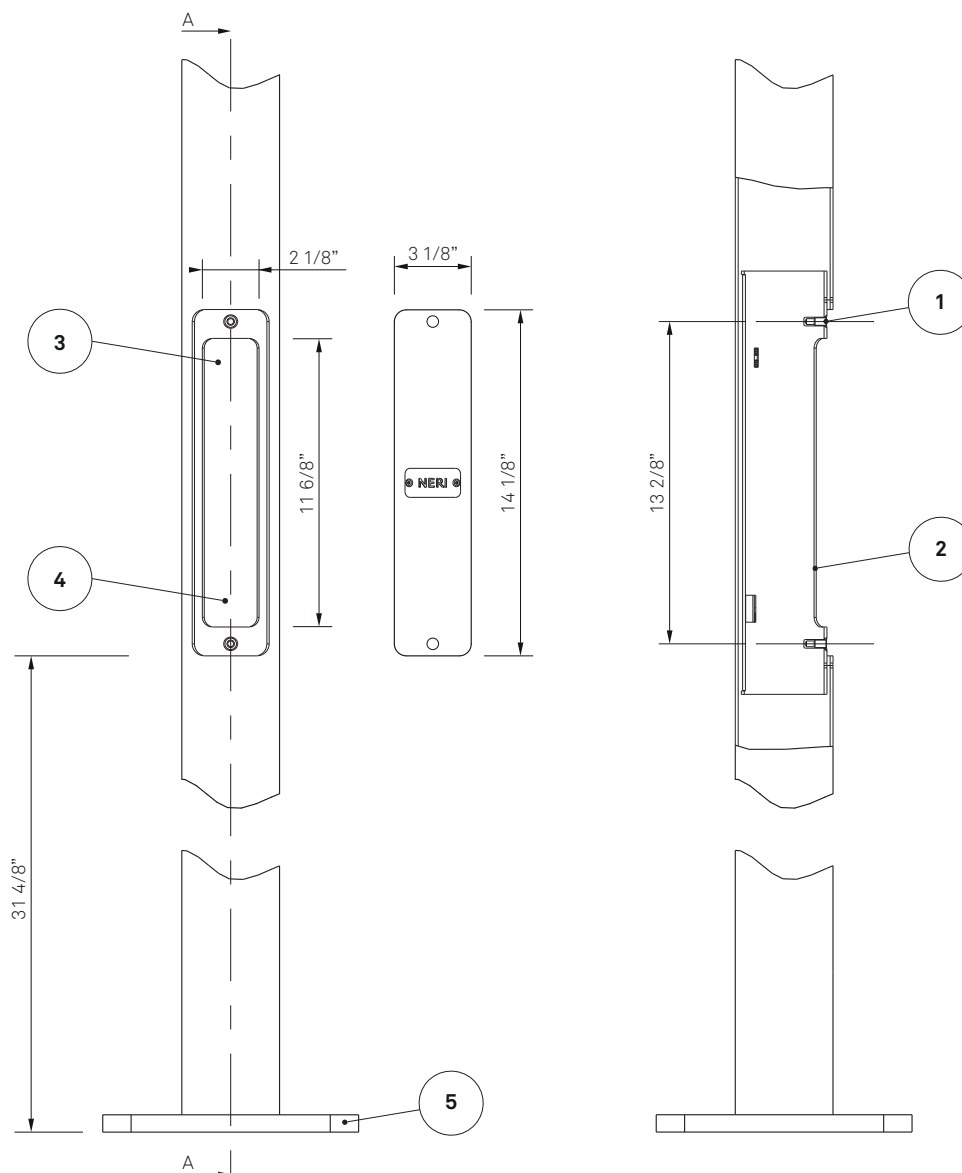
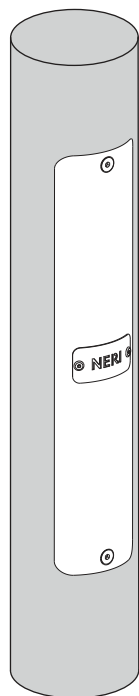

Fig. D

Project location:			
Project name:			
Model #:	HAND HOLE	Date	

HAND HOLE



Legend

- 1 - M6 threaded insert for door closing
- 2 - Hand hole stop
- 3 - Terminal block fixing
- 4 - Post grounding fixing pocket
- 5 - Flange

Hand hole for posts H 15' and H 18'

Cod. ANEB.501.203

Cod. ANEB.501.205

Cod. ANEB.601.203

Cod. ANEB.601.207



Unscrew the two M6 screws (Fig. 1) and remove the door (Fig. 2) to inspect the post and install the terminal block (not supplied).

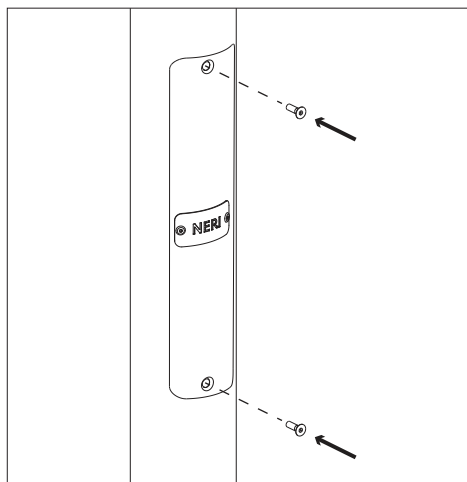

1

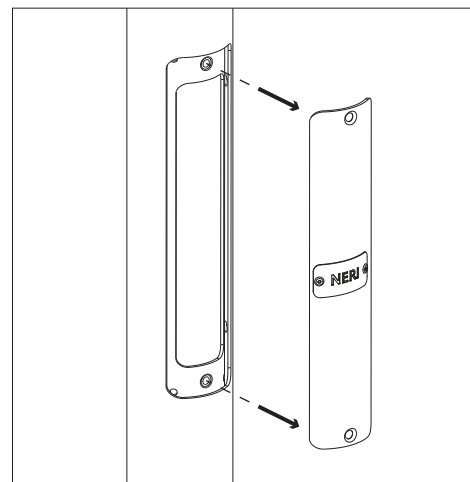

2

Project location:			
Project name:			
Model #:	HAND HOLE	Date	

HAND HOLE

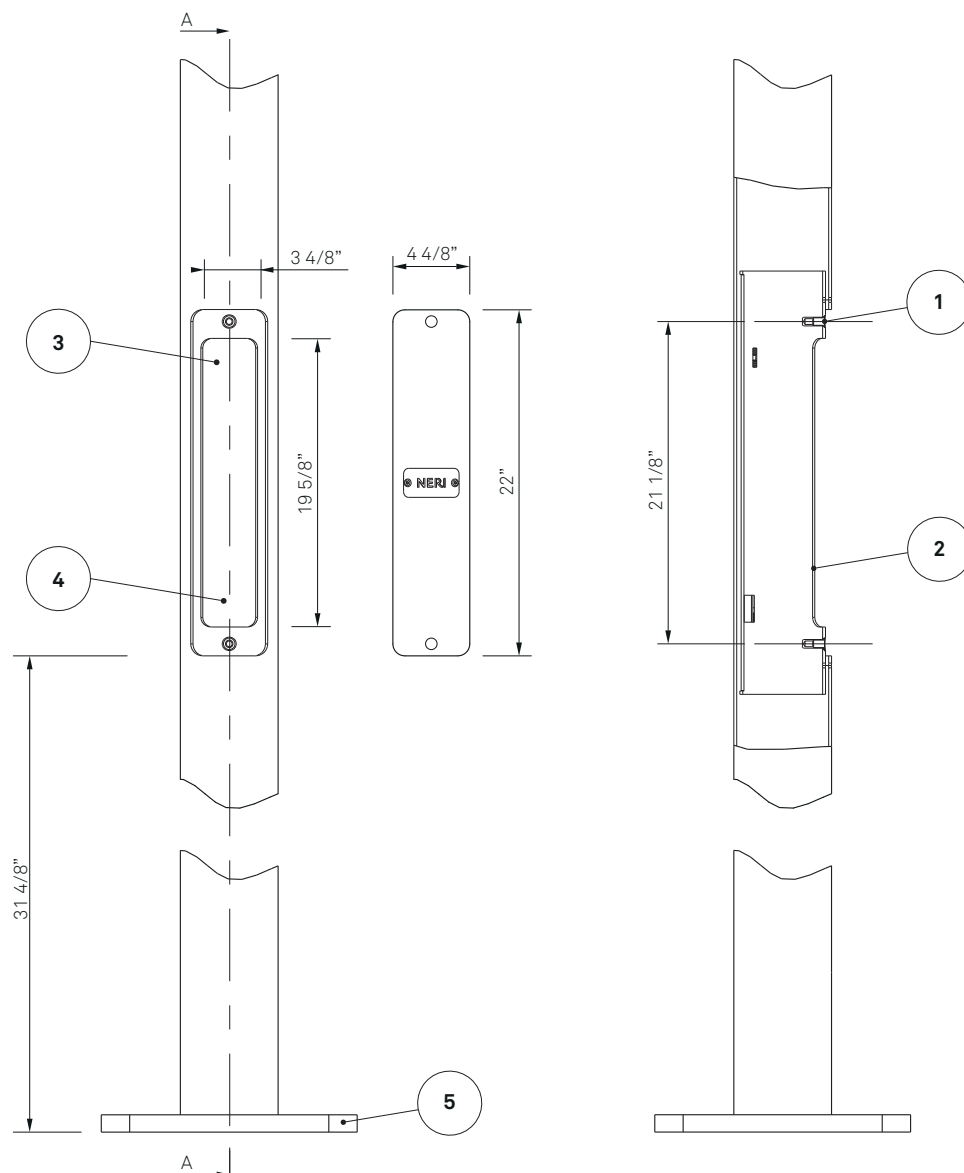
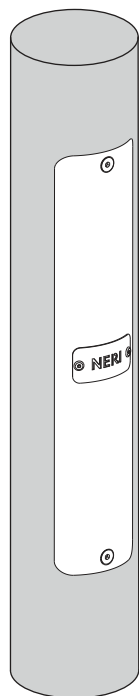

Legend

- 1 - M6 threaded insert for door closing
- 2 - Hand hole stop
- 3 - Terminal block fixing
- 4 - Post grounding fixing pocket
- 5 - Flange

Hand hole for posts H 21' and H 24'

Cod. ANEB.701.203

Cod. ANEB.701.209

Cod. ANEB.801.203

Cod. ANEB.801.211



Unscrew the two M6 screws (Fig. 1) and remove the door (Fig. 2) to inspect the post and install the terminal block (not supplied).

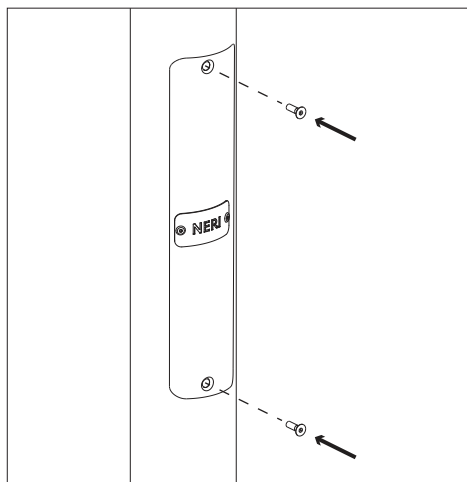

1

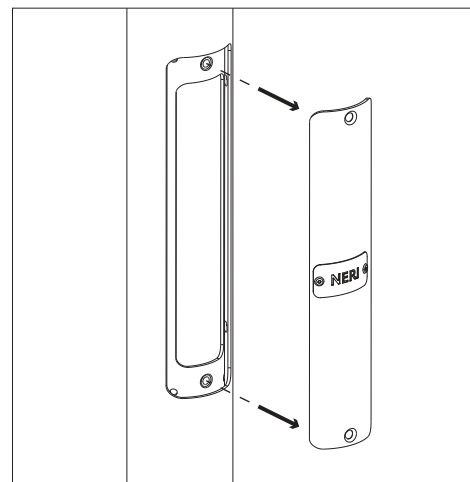

2

Project location:			
Project name:			
Model #:	FIXING DEVICES	Date	

FIXING DEVICES

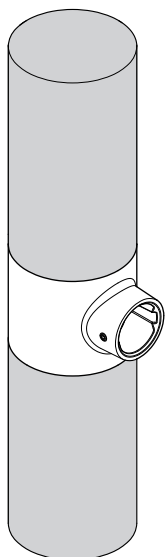

Fixing devices for accessories Posts H 15' and H 18'

Cod. 0006.004.078

Cod. 0006.004.079

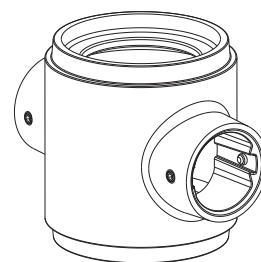
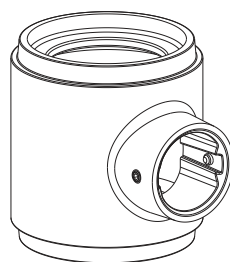

Fixing devices for accessories Posts H 21' and H 24'

Cod. 0006.004.080

Cod. 0006.004.081

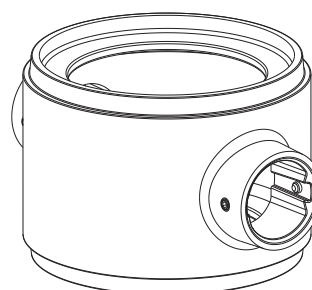
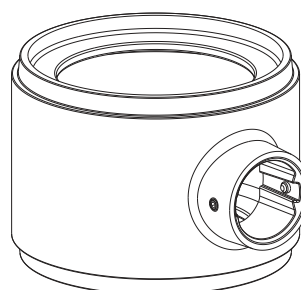

The fixing devices, in single or double version, allow the installation of accessories and luminaires to the type of post chosen. The permissible rotation of the fixing device for the luminaires is 360°.

Using the double element the accessories / luminaires are placed at 180°.

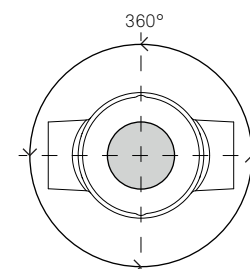
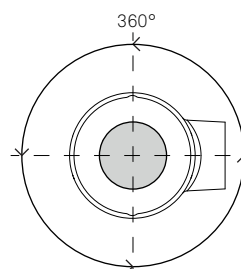

Fixing devices for luminaires Posts H 15' and H 18'

Cod. 0006.004.072

Cod. 0006.004.073

Cod. 0006.004.076

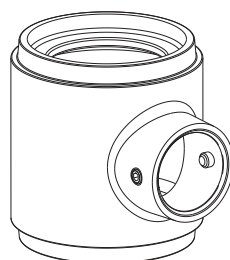
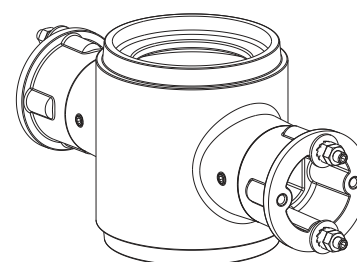
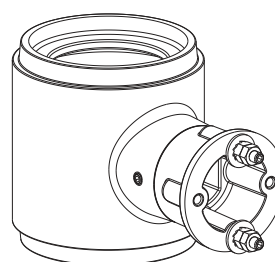

Project location:			
Project name:			
Model #:	FIXING DEVICES	Date	

FIXING DEVICES

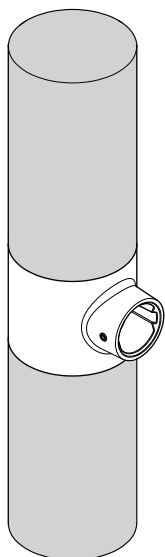

Fixing devices for luminaires Posts H 21' and H 24'

Cod. 0006.004.074

Cod. 0006.004.075

Cod. 0006.004.077

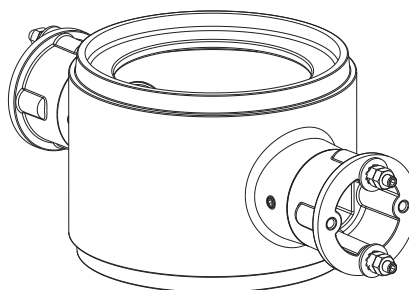
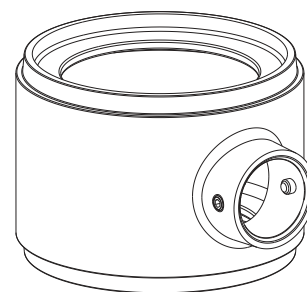
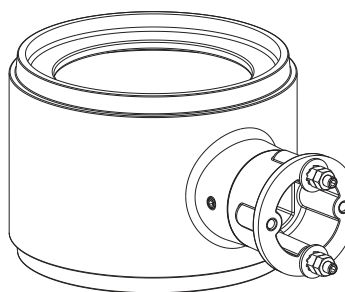

The fixing devices, in single or double version, allow the installation of accessories and luminaires to the type of post chosen. The permissible rotation of the fixing device for the luminaires is 360°.

Using the double element the accessories / luminaires are placed at 180°.

Fixing devices for accessories and luminaires

Posts H 15' and H 18'

Cod. 0006.004.084

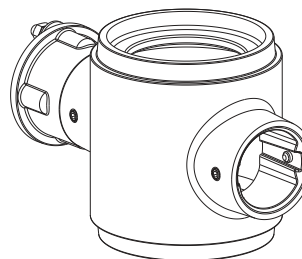

Fixing devices for accessories and luminaires

Posts H 21' and H 24'

Cod. 0006.004.085

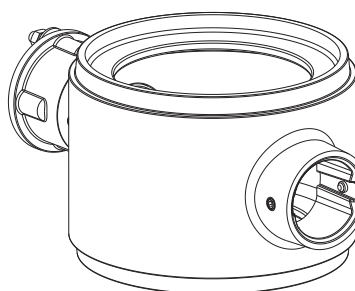

Project location:			
Project name:			
Model #:	FIXING DEVICES	Date	

FIXING DEVICES



Fix the main structure of the pole (Fig. 1) and insert the fastener to be used from above (Fig. 2) until the desired position is reached (Fig. 3).

The permissible rotation of the lighting fitting is 360°.
Rotate only after the power cables have been routed and the luminaire installed.

NOTE:
Use fasteners suitable for the type of configuration chosen.
The installation of the fasteners is the same for all Nebula system configurations.

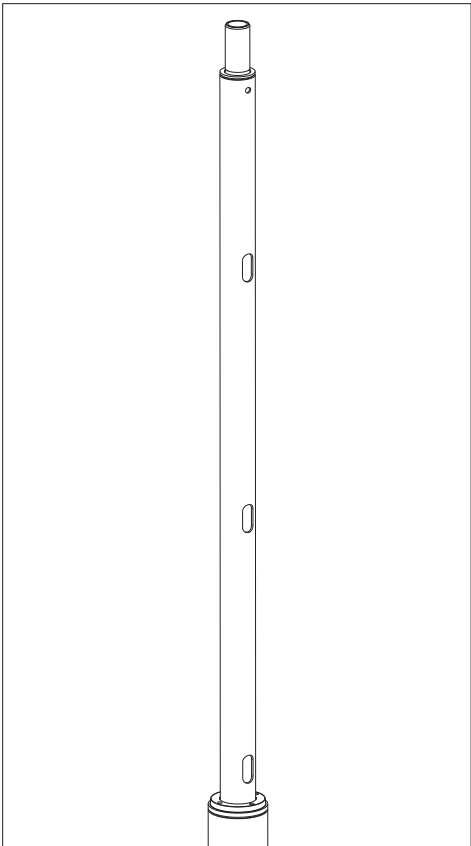

1

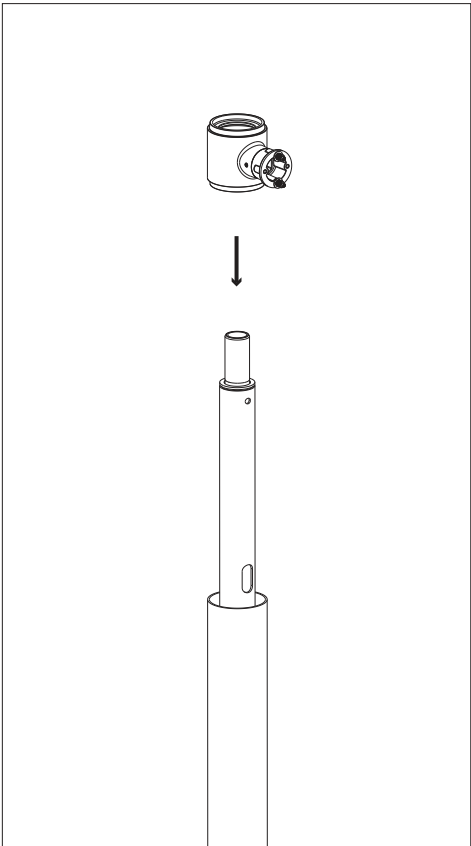

2

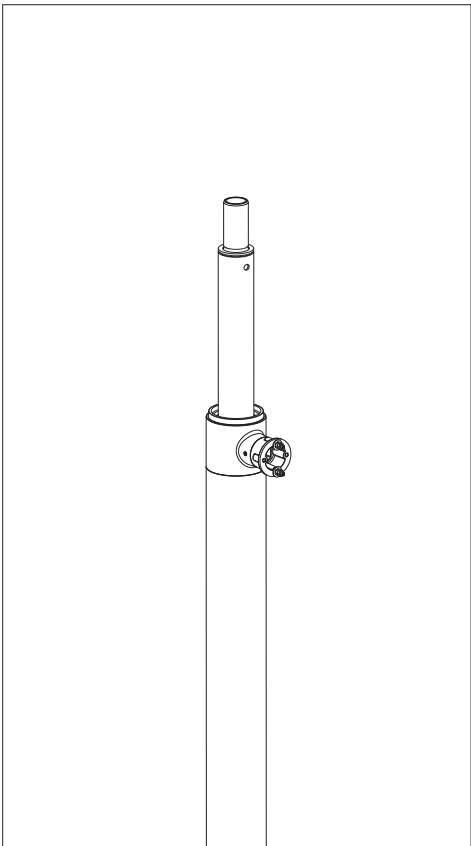

3

Project location:			
Project name:			
Model #:	FIXING DEVICES	Date	

FIXING DEVICES



If an accessory is installed in the first slot, the dedicated compensation ring (Fig. 4) must first be inserted, followed by the fixing device (Fig. 5-6).

NOTE:
Use fasteners suitable for the type of configuration chosen.
The installation of the fasteners is the same for all Nebula system configurations.

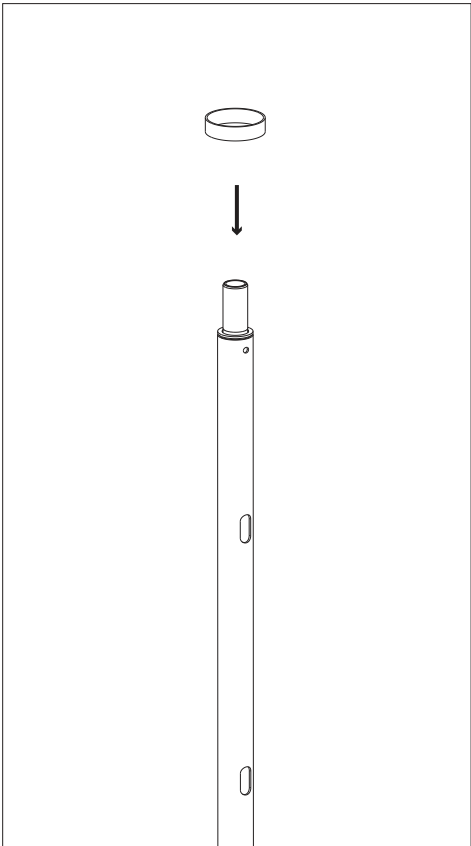

4

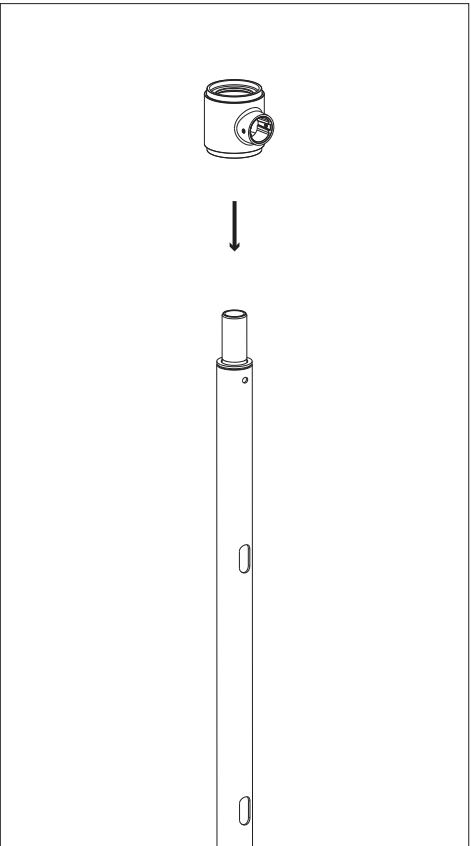

5

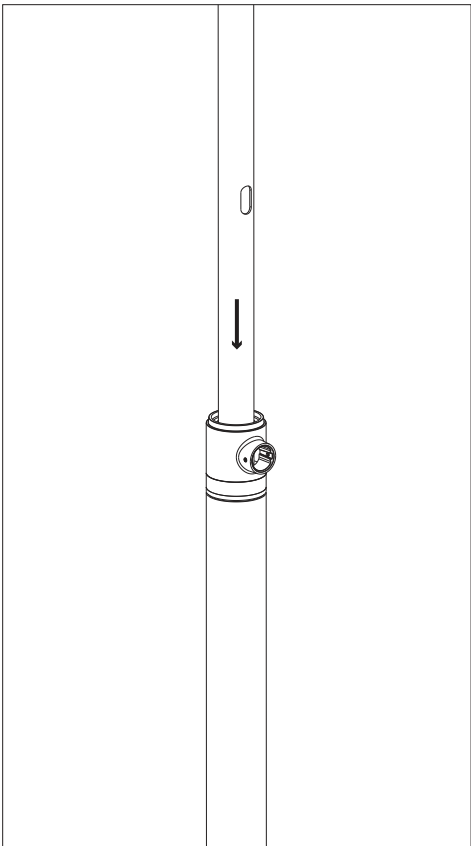

6

Project location:			
Project name:			
Model #:	COMPENSATION TUBE	Date	

COMPENSATION TUBE

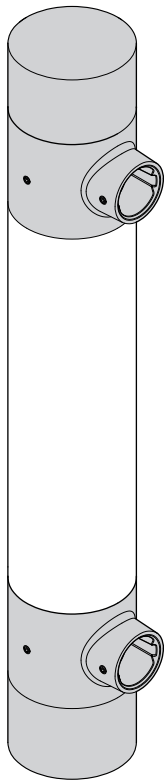

Compensation tubes
Posts ANEB.701.203,
ANEB.701.209 - ANEB.801.203,
ANEB.801.211

Cod. 9525.388.103

Cod. 9525.388.104

Cod. 9525.388.105

Cod. 9525.388.106

Cod. 9525.388.107

Cod. 9525.388.108

Cod. 9525.388.109

Cod. 9525.388.110

Cod. 9525.388.111

Cod. 9525.388.112

Cod. 9525.388.113

Cod. 9525.388.114

Cod. 9525.388.115

Cod. 9525.388.116

Cod. 9525.388.117

Cod. 9525.388.118

Cod. 9525.388.119

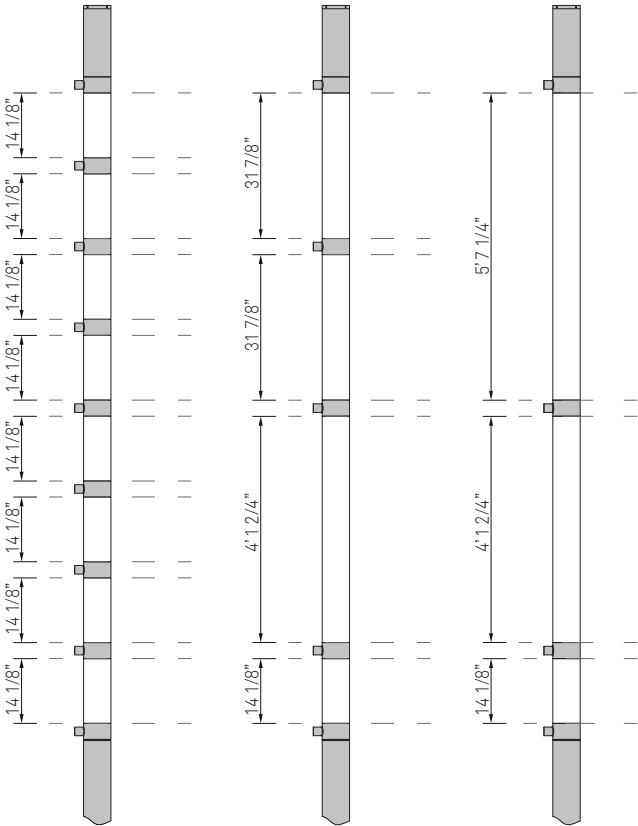

Example of compensation tubes with configuration cod. ANEB.701.209

The compensation tubes are made of steel and hot-dip galvanized.
The number and length of modular elements are determined by the final configuration of the chosen system.

Project location:			
Project name:			
Model #:	COMPENSATION TUBE	Date	

COMPENSATION TUBE

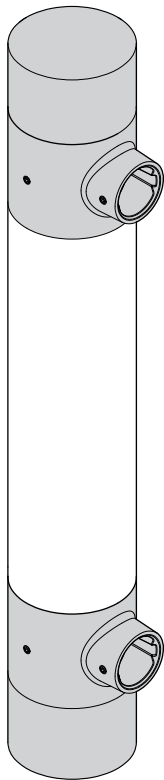

Compensation tubes
Posts ANEB.501.203,
ANEB.501.205, ANEB.601.203,
ANEB.601.207

Cod. 9525.388.094

Cod. 9525.388.095

Cod. 9525.388.096

Cod. 9525.388.097

Cod. 9525.388.098

Cod. 9525.388.099

Cod. 9525.388.100

Cod. 9525.388.101

Cod. 9525.388.102

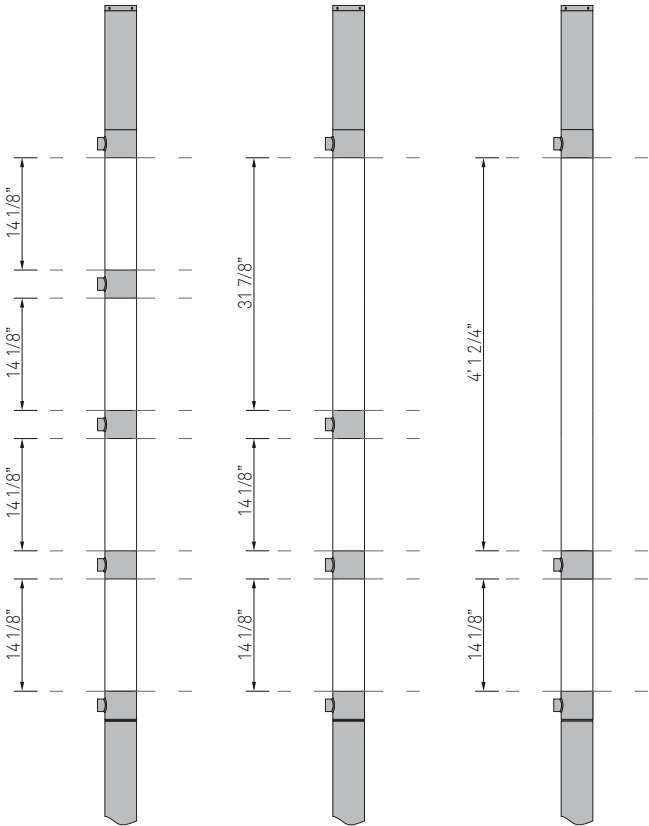

Example of compensation tubes with configuration cod. ANEB.501.205

The compensation tubes are made of steel and hot-dip galvanized.
The number and length of modular elements are determined by the final configuration of the chosen system.

Project location:			
Project name:			
Model #:	COMPENSATION TUBE	Date	

COMPENSATION TUBE



Insert the compensation tube to be used from above (Fig. 1-2).

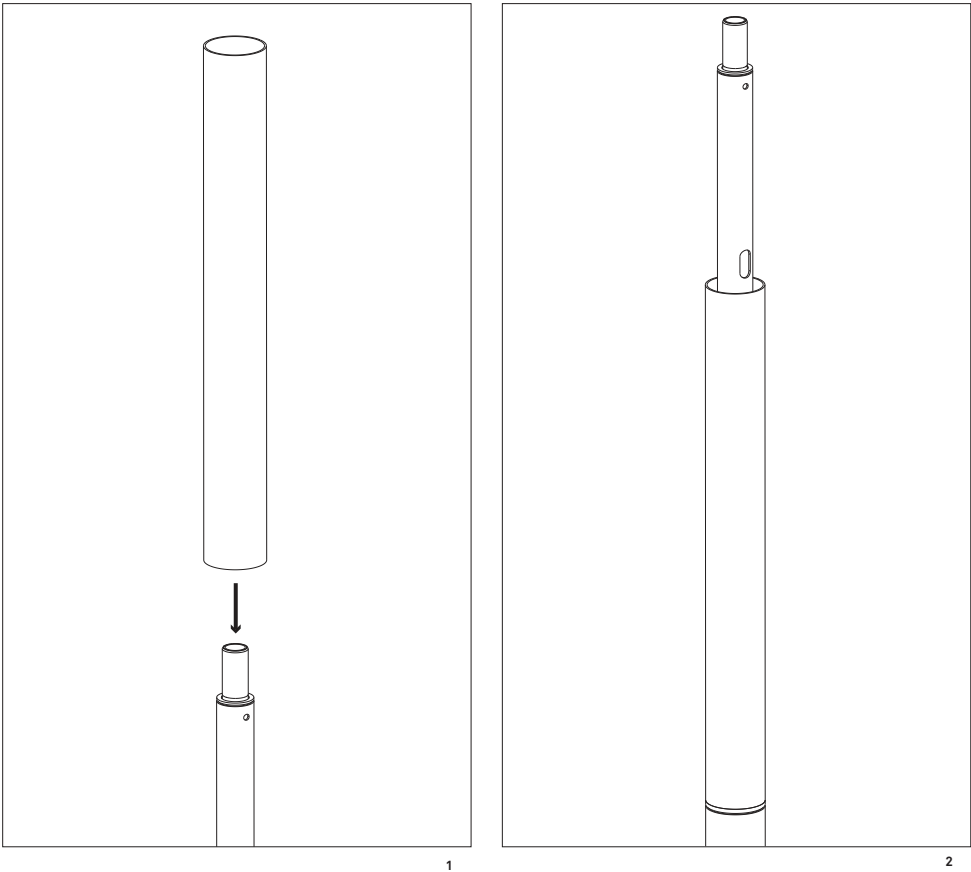

Project location:			
Project name:			
Model #:	LOCKING ELEMENT	Date	

LOCKING ELEMENT

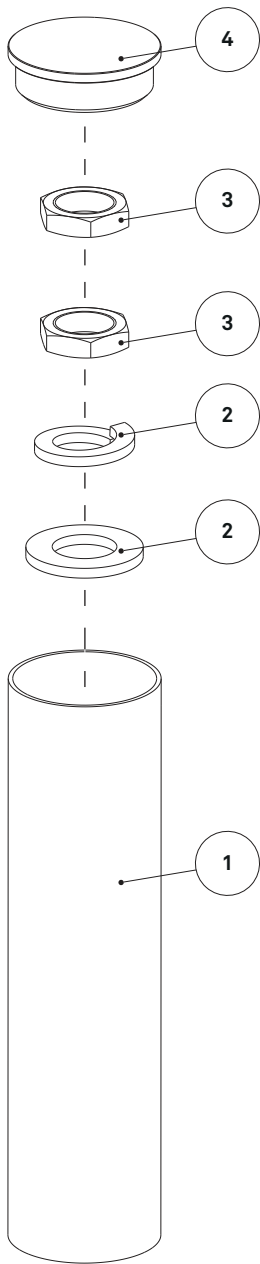
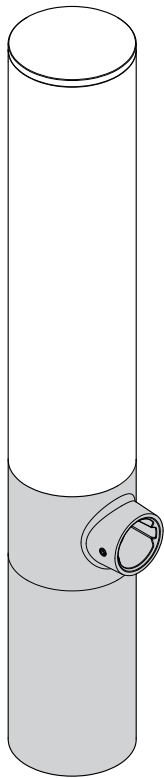

- Legend**
- 1 - Compensation tube
 - 2 - Flat washer
 - 3 - Steel nut
 - 4 - Closing cover

The closing tube enables the fixing of the components to the post core.
The assembly is completed by a cover placed at the top end and fixed with four screws.

Project location:			
Project name:			
Model #:	LOCKING ELEMENT	Date	

LOCKING ELEMENT



Install the elements of the chosen configuration (Fig. 1) and insert the locking tube from above until reaching the fixing device (Fig. 2).
Insert the two non-screwing flat washers and the two steel nuts (Fig. 3).
Insert the closing cover from above (Fig. 4).

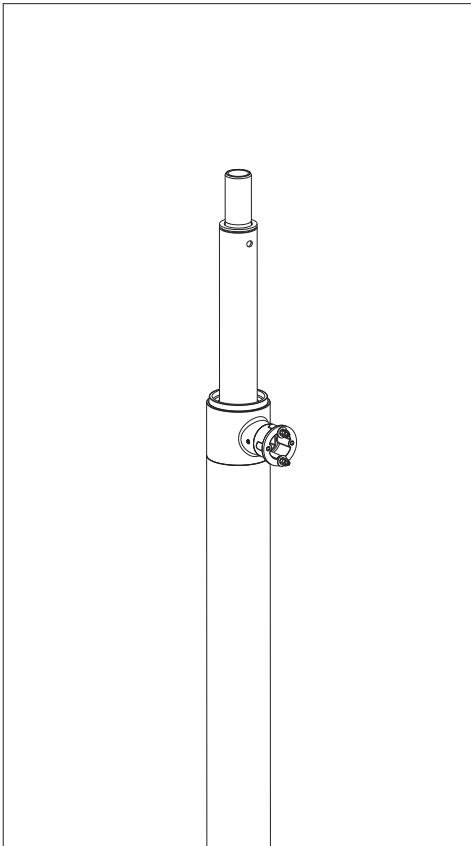

1

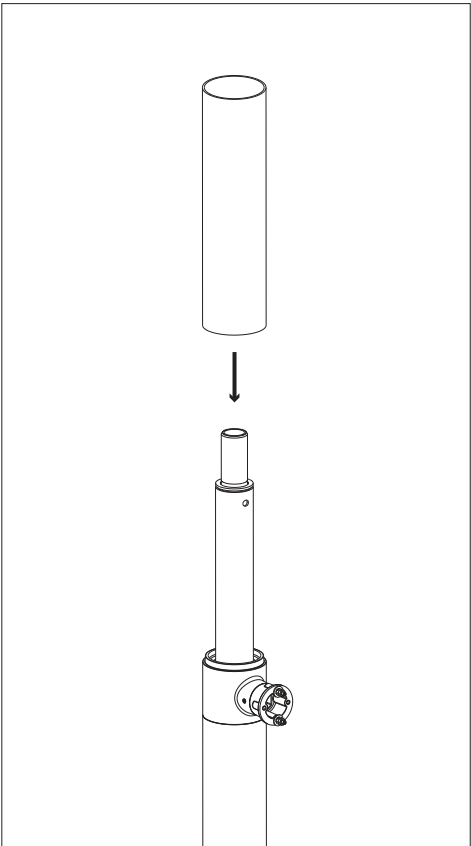

2

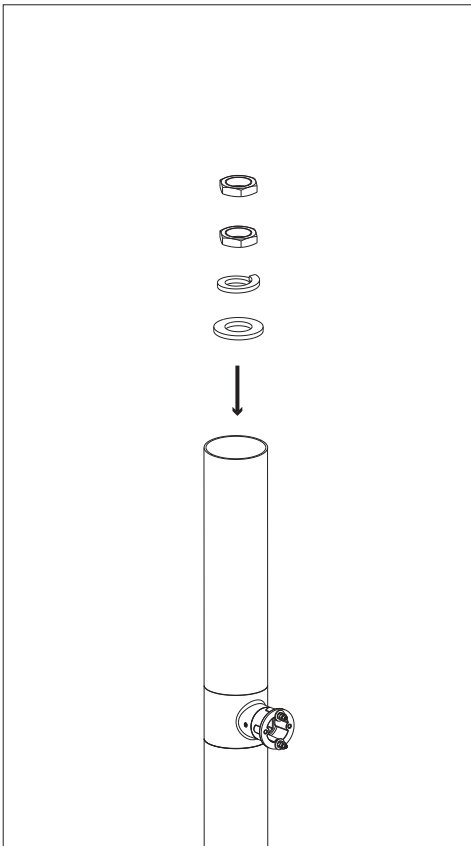

3

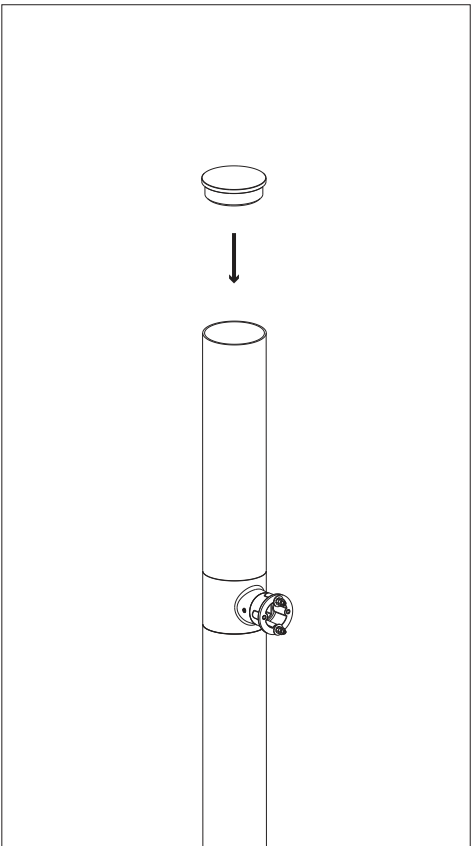

4

Any reproduction and use for its own purposes of this manual is not permitted. All rights reserved.
Reproduction of this manual, even partially, is forbidden without written consent from Neri SpA. Neri SpA reserves the right to modify its products and documentation without obligation to give prior warning.

Neri North America
1547 NW 79th ave
Miami, FL 33126
T +1 786 315 4367 EXT 404
M +1 786 897 3022
www.nerinorthamerica.com